



Optional black interior finish

STANDARD

4 levels of removable, adjustable, and tiltable shelves | Self-closing hinged doors with double tempered glass | Display area in skinplate | Front decoration in painted plate (RAL) | Solid sides | Ventilated refrigeration | Vertical LED lighting | Electronic temperature controller | Programmable automatic defrosting | Electric evaporation of defrost water | Adjustable feet | Self-contained

OPTIONS

Display area in painted plate (RAL) | Display area in AISI 304 stainless steel | Exterior decoration in painted plate (RAL) | Exterior decoration in AISI 304 stainless steel | Treated evaporator | Castors with brakes | Voltage 115 V-60 Hz / 120 V-60 Hz / 220 V-60 Hz



Ventilated



Automatic



230V | 1 Ph | 50 Hz



Plug-in



-6° to -1°F | 33° to 39°F



LED



L1/M1 | 25°C | H.R. 60%



R290 ECO Friendly

| | |
|---|---|
| Operating temperature | -1° to -6° F / -21 to -18°C or 33° to 39°F / 0 to 4°C |
| Refrigerant (ref/GWP) | R290/3 |
| Defrost | Electric |
| External dimensions (LxHxD) | 78"x31"x80" / 1982x788x2032 mm |
| TDA (m ²) | 30 sq ft / 2.13 sq m |
| Net volume (l) | 30.6 cu ft / 867 L |
| Refrigerated shelf area (m ²) | 40.6 sq ft / 3.77 sq m |
| Insulation | PUR/H2O |
| Nominal power (W) | 2906 |
| Electric current (A) | 14.23 |
| Total energy consumption (kWh/24h) | 28.700 - |
| Annual energy consumption (kWh/annum) | 10475.50 - |
| Energy efficiency class* | - |

*The information presented regarding the energy class (Energy Labeling regulation and Eco Design regulation) is only related to the standard models. For the energy class of the equipments with different options that involve elements of energy consumption and/or changes in the construction of the unit, please contact the manufacturer directly

**Pictures and colors are not contractual. The information presented refers to the standard equipments in plug-in version. For additional information about remote our neutral units, contact the manufacturer.

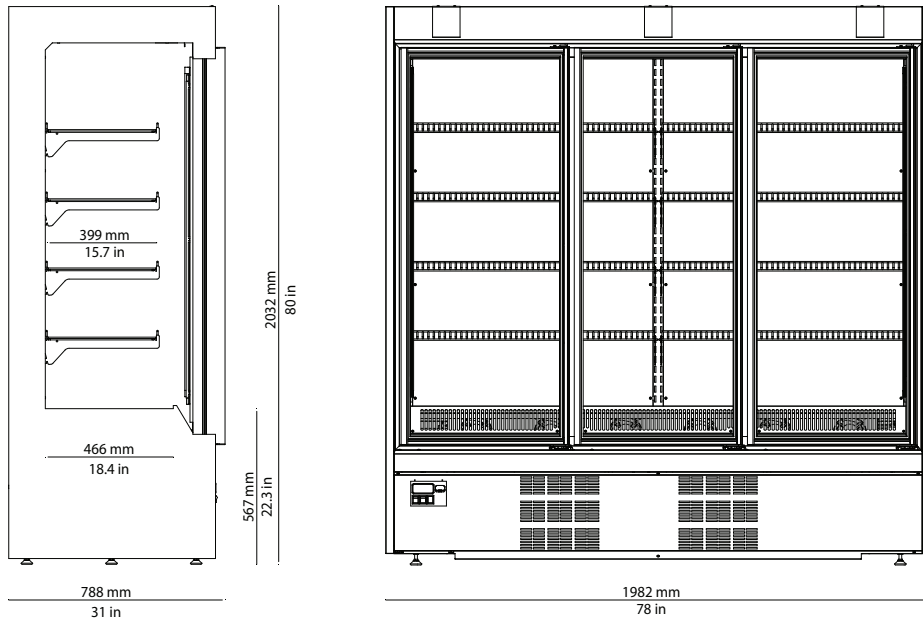

78"x31"x80" / 1982x788x2032 mm



www.mvpgroupcorp.com

3560 NW 56th Street
 Fort Lauderdale, FL 33309
 Tel.: 786.600.4687 / Toll Free: 888.275.4538
 sales@mvpgroupcorp.com
 customerservice@mvpgroupcorp.com