



SERVING THE FOOD INDUSTRY SINCE 1951

## White Display Refrigerators, Glass Doors

ITEM:	50032	52032	50033	50035	50036	50052
MODEL:	RE-CN-0045-HC	RE-CN-0045-HC-SW	RE-CN-0009-HC	RE-CN-0014-H	RE-CN-0023-HC	RE-CN-0052-HC



### Attractively display your products and increase impulse sales.

The refrigerator's glass doors enhance product visibility and draw customer attention, making it ideal for supermarkets, cafés, and delis. Combining ample storage with a stylish design, it elevates both the appearance and functionality of your business. The spacious cabinet features multiple adjustable shelves, allowing you to maximize storage and customize the layout to suit your needs.

Equipped with a powerful, environmentally friendly R290 refrigeration system, it keeps ingredients and prepared foods safely chilled. Its bottom-mounted compressor improves energy efficiency and raises the bottom shelf for easier access, reducing the need to bend during loading and unloading. The digital temperature control with a clear LCD readout makes monitoring and adjusting the temperature simple, while the automatic defrost system eliminates ice buildup, saving valuable cleaning time.

#### FEATURES:

- Adjustable shelves
- Powerful, environmentally safe refrigeration system
- Bottom mounted compressor for energy efficiency
- Digital Temperature Control & LCD display
- Autodefrost System

Telephone: 1-800-465-0234

Fax: (905) 607-0234

Email: [sales@omcan.com](mailto:sales@omcan.com)

Website: [www.omcan.com](http://www.omcan.com)



Authorized Dealer



Made in China

(Version 2025.8)

Page 1 / 5

TECHNICAL SPECIFICATION			
Features	22" wide / 9.1 cu. ft. -1 Swing Door	53" wide/ 45 cu. ft. - 2 Sliding Doors	53" wide/ 45 cu. ft. - 2 Swinging Doors
Item	50033	50032	52032
Model	RE-CN-0009-HC	RE-CN-0045-HC	RE-CN-0045-HC-SW
Capacity	9.1 cu. ft./ 257L	45 cu. ft./ 1274 L	
Number of Doors	1 Swing Glass Door	2 Sliding Glass Doors	2 Swing Glass Doors
Self-Closing Door	Yes		
Material	Interior & Exterior: Stainless steel with aluminum back		
Number of Shelves	4	8	
Shelf Capacity	55.1 lbs/ 25 kgs	90 lbs/ 41 kgs	
Shelf Material	Plastic Coated		
Number of Casters	N/A		4
Power	1/5 HP	1/4 HP	
Current	2.9A	4.3A	
Electrical	110-120V / 60Hz / 1Ph		
Temperature Controller	Digital		
Temperature Range	0.5°C - 5°C (33°F - 41°F)		
Refrigerant	R290		
Insulation Material	Cyclopentane		
Cooling System	Ventilated		
Defrosting	Automatic		
Interior Dimensions (WDH)	18.9" x 18.3" x 46" / 480 x 465 x 1168 mm	50" x 28.3" x 62" / 1351 x 807 x 2133 mm	
Net Weight	161 lbs/ 73 kgs	441 lbs/ 200 kgs	
Net Dimensions (WDH)	21.7" x 21.7" x 63" / 551 x 551 x 1600 mm	53.2" x 31.8" x 84" / 1351 x 807 x 2133 mm	
Gross Weight	225 lbs/ 102 kgs	481 lbs/ 218 kgs	
Gross Dimensions (WDH)	24" x 25" x 69" / 599 x 630 x 1755 mm	56" x 34" x 85" / 1422 x 850 x 2148 mm	
Plug Type	NEMA 5-15P		

*\* This equipment is intended for indoor environment using where ambient temperature do not exceed 26°C(80°F) & 55% relative humidity*

TECHNICAL SPECIFICATION			
Features	26" wide / 14 cu. ft. / 396 L Capacity	28" wide / 23 cu. ft. / 651 L Capacity	78" wide / 53 cu. ft. / 1500 L Capacity
Item	50035	50036	50052
Model	RE-CN-0014-H	RE-CN-0023-HC	RE-CN-0052-HC
Capacity	14 cu. ft. / 396 L	23 cu. ft. / 651 L	53 cu. ft. / 1500 L
Number of Doors	1 Swing Door - Glass Door	1 Swing Door - Glass Door	3 Swing Doors - Glass Door
Self-Closing Door	Yes		
Material	Interior & Exterior: Stainless steel with aluminum back		
Number of Shelves	4		12
Shelf Capacity	77 lbs / 35 kgs	90 lbs / 41 kgs	
Shelf Material	Plastic Coated		
Number of Casters	N/A	Yes	
Power	1/5 HP		3/4 HP
Current	2.88 A	3 A	10.7 A
Electrical	110-120V / 60Hz / 1Ph		
Temperature Controller	Digital		
Temperature Range	0.5°C - 5°C (33°F - 41°F)		
Refrigerant	R290		
Insulation Material	Cyclopentane		
Cooling System	Ventilated		
Defrosting	Automatic		
Interior Dimensions (WDH)	22.8" x 19.8" x 55" / 579 x 503 x 1397 mm	25.2" x 28.3" x 62.3" / 640 x 719 x 1582 mm	73.7" x 25.6" x 55.7" / 1872 x 650 x 1415 mm
Net Weight	220 lbs / 99.8 kgs	320 lbs / 145.2 kgs	615 lbs / 279 kgs
Net Dimensions (WDH)	25.6" x 22.8" x 79.4" / 650 x 579 x 2017 mm	28.3" x 31.9" x 83.6" / 719 x 810 x 2123 mm	78.3" x 29.9" x 84.6" / 1988 x 759 x 2150 mm
Gross Weight	270 lbs / 122 kgs	355 lbs / 161 kgs	720 lbs / 326 kgs
Gross Dimensions (WDH)	48" x 40" x 90" / 1219 x 1016 x 2286 mm		84" x 36" x 86" / 2133 x 914 x 2184 mm
Plug Type	NEMA 5-15P		NEMA 5-20P

\* This equipment is intended for indoor environment using where ambient temperature do not exceed 26°C(80°F) & 55% relative humidity

## TECHNICAL DRAWING (measurements are in mm)

22" Wide-50033

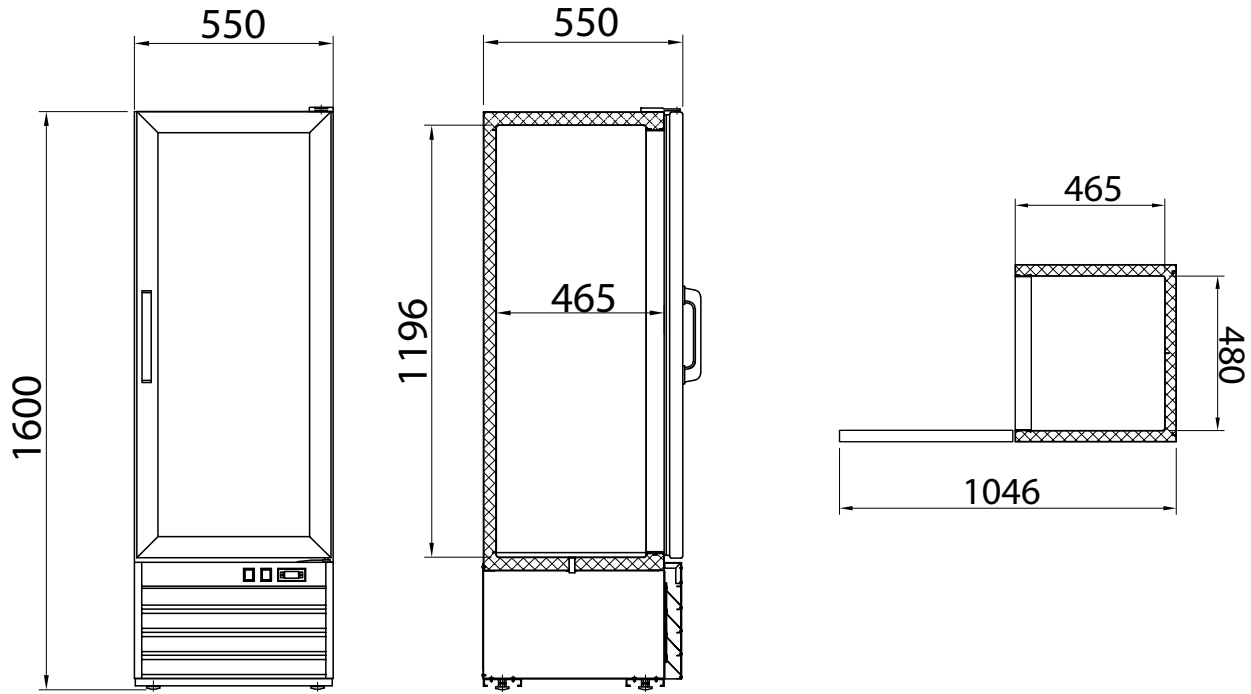

53" Wide- 50032 & 52032

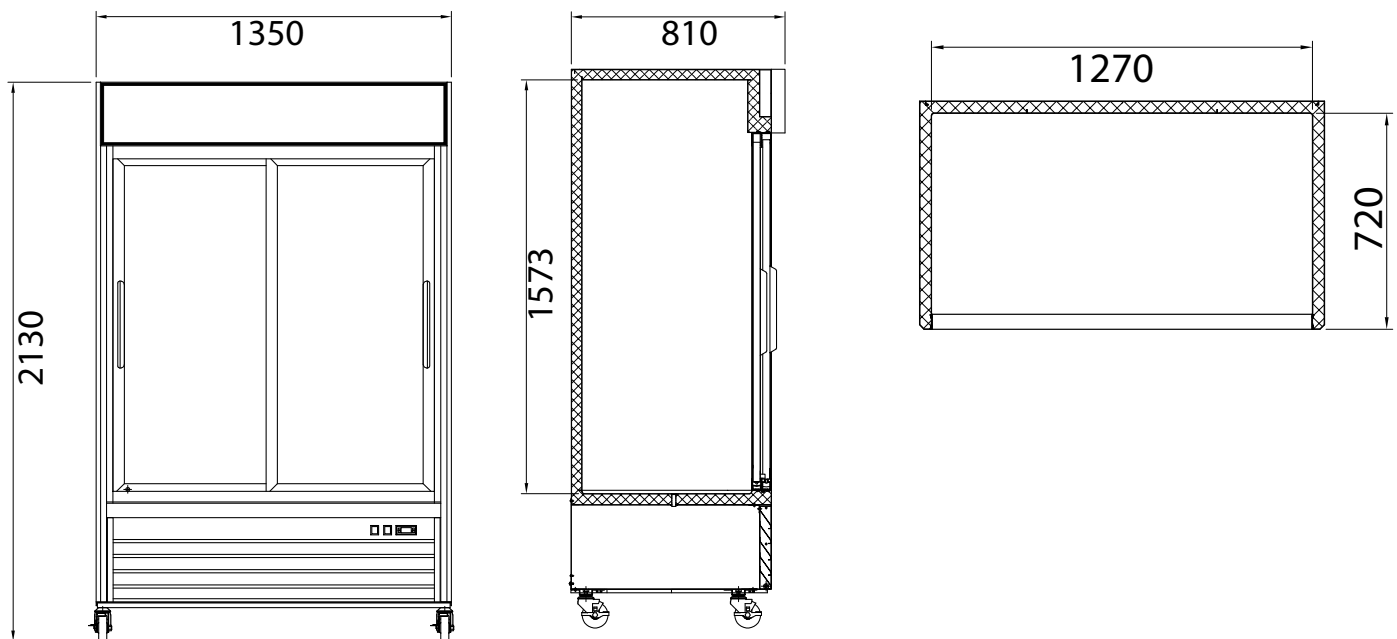

## TECHNICAL DRAWING (measurements are in inches)

28" Wide- 50036

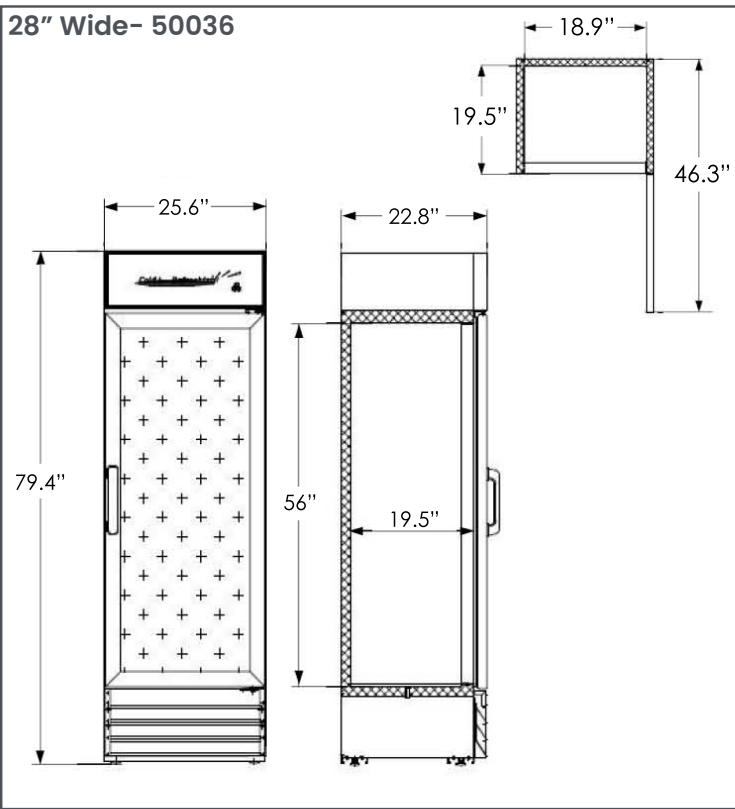

26" Wide-50035

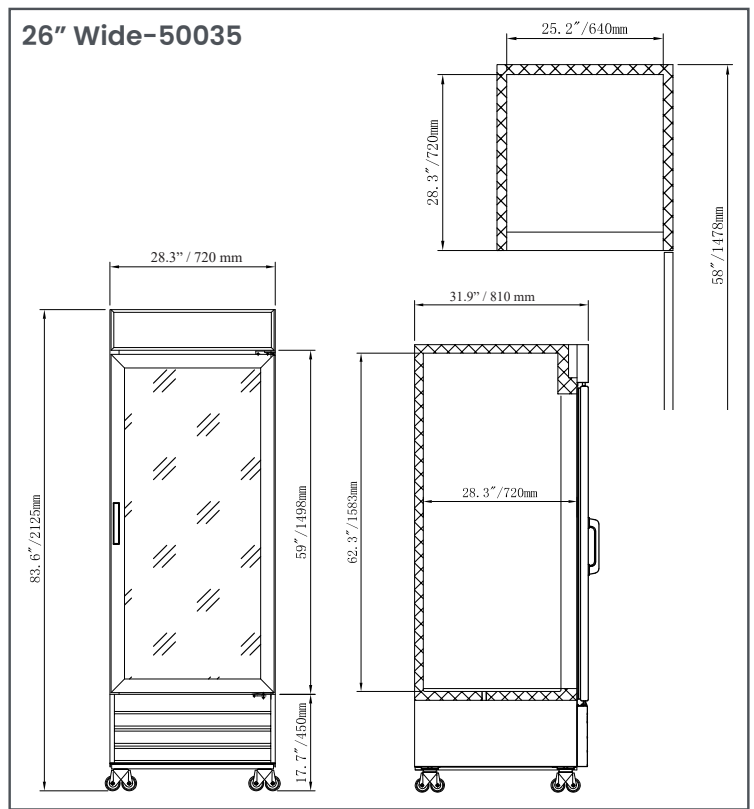

78" Wide- 50052

